

Land in El Rosario

Reference: R3888871



Bedrooms: by request  
Status: Sale

Bathrooms: by request  
Property Type: Land

M<sup>2</sup> Build size:  
Parking places: by request

Price: 975,000 €  
M<sup>2</sup> Plot Size: 1,704

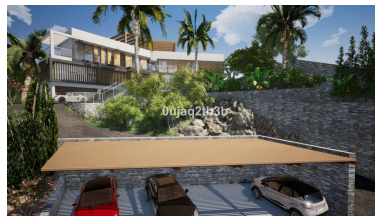

Overview: Magnificent plot in a great location and walking distance to Sports center, commercial center, services and amenities. There is a project to build a very large house taking advantage of the slope in the plot. South-West oriented. El Rosario is a consolidated residential area with high demand for plots and properties.

Features:

Mountain views, Private garden, Investment, Resale