

Commercial in Puerto Banús

Reference: R4333858



Bedrooms: 2
Status: Sale

Bathrooms: by request
Property Type: Commercial

M² Build size: 227
Parking places: by request

Price: 1,029,000 €
M² Plot Size:

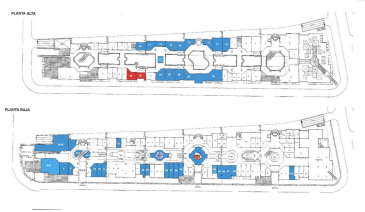

Overview: These are two units linked together. Cristamar is a mall comprises by 114 local comercial in the heart of Puerto Banus, three levels with underground parking for your clients on the ground floor restaurants , shops, and services, pharmacy at the north corner a gym, and on the second floor offices

Features:

Air conditioning, Lift, Investment, Resale